

# PT. CHEHALIS DISPOSAL SITE (FY19 HOPPER O&M DREDGING)

US Army Corps  
of Engineers  
Seattle District

MARCH 2019

SOUTH JETTY DISPOSAL SITE (SJDS)	POINT CHEHALIS DISPOSAL SITE (PCDS)
<b>STATIC CAPACITY:</b> - SJDS: TO -44' MLLW: N/A	<b>STATIC CAPACITY:</b> - PCDS TARGET TO -50' MLLW: 820,400 CY
<b>DYNAMIC CAPACITY:</b> - SJDS: 2 x STATIC: N/A	<b>DYNAMIC CAPACITY:</b> - PCDS: 2x the static capacity: 1.6 MCY

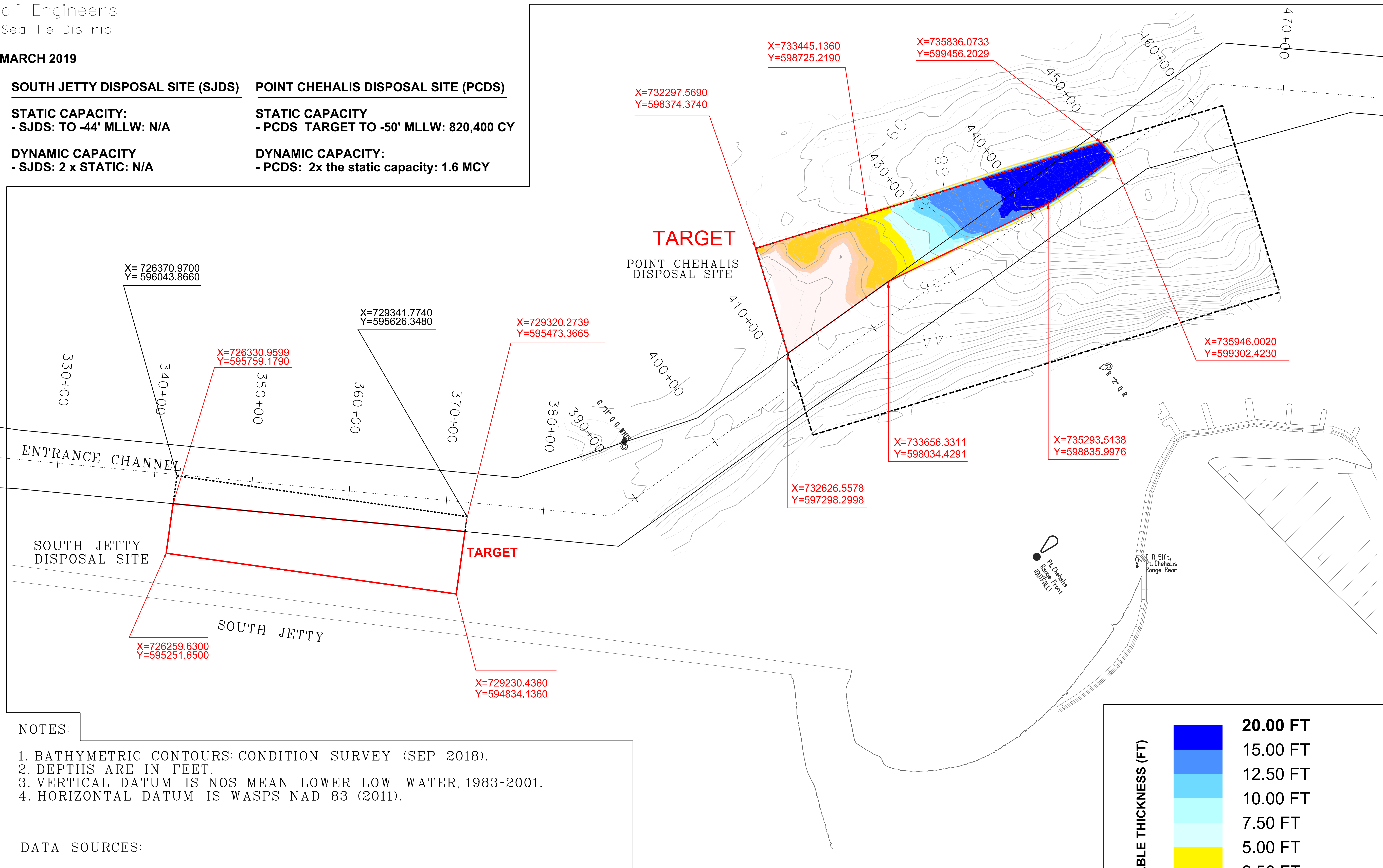

### NOTES:

1. BATHYMETRIC CONTOURS: CONDITION SURVEY (SEP 2018).
2. DEPTHS ARE IN FEET.
3. VERTICAL DATUM IS NOS MEAN LOWER LOW WATER, 1983-2001.
4. HORIZONTAL DATUM IS WASPS NAD 83 (2011).

### DATA SOURCES:

PCDS CONDITION SURVEY - 14 SEP 2018 (2018gr092.xyz)  
 SJDS CONDITION SURVEY -

